

These instructions are to be used only as a reference. Read the **INSTRUCTIONS FOR USE** that come with the drainage kits and watch the **DRAINAGE VIDEO** for more detailed instructions.

GETTING STARTED

Get all drainage supplies ready and thoroughly wash your hands.

1. Open all packaging. Unfold blue wrapping. Place bottle near wrapping and lay access tip on blue wrapping (*Diagram 1*).
2. Pick up each glove by the wrist and put both of them on (*Diagram 2*).
3. Tear open alcohol pads. Lay open pouches on blue wrapping a short distance from sterile items.
4. Open pouch containing valve cap and let it fall onto sterile blue wrapping (*Diagram 3*).

Diagram 1

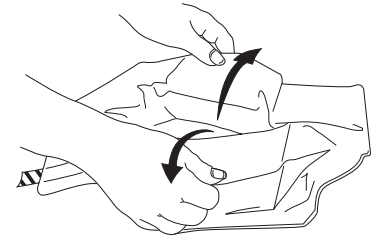
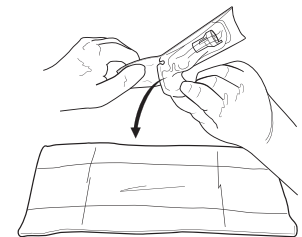

Diagram 2



Diagram 3



CONNECTING THE DRAINAGE BOTTLE

Be sure to keep the end of the catheter and access tip clean.

5. Squeeze clamp on drainage line completely closed and remove cover from access tip (*Diagram 4*).
6. Take valve cap off catheter (*Diagram 5*).
7. Clean around valve opening with first alcohol pad (*Diagram 6*).
8. Insert access tip into catheter valve (*Diagram 7*).

Diagram 4

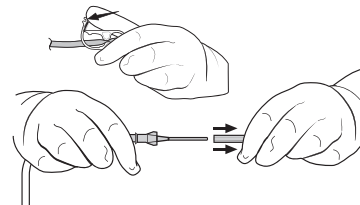

Diagram 5

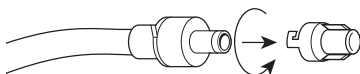

Diagram 6

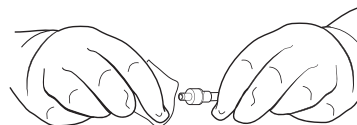
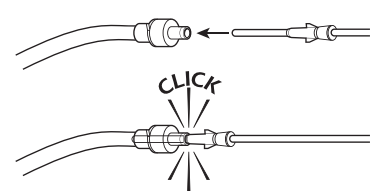

Diagram 7



This information was created and reviewed through a partnership with the UAMS Patient and Family Advisory Councils.

DRAINING FLUID

Do not drain more than 1000mL from your chest or 2000mL from your abdomen at any one time.

9. Remove support clip from top of drainage bottle and push down “T” plunger (*Diagram 8*).
10. Release clamp on drainage line to begin draining (*Diagram 9*).
11. Squeeze clamp on drainage line completely closed when finished draining.

Diagram 8

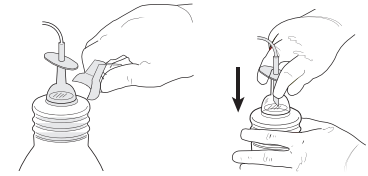
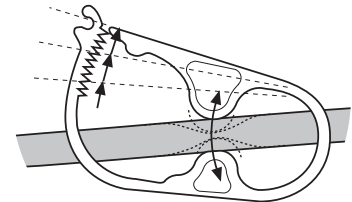

Diagram 9



FINAL STEPS AND DISPOSAL

If you have any questions or concerns, contact your doctor or nurse.

12. Pull access tip out of valve; set drainage line down (*Diagram 10*).
13. Clean around valve opening with second alcohol pad (*Diagram 11*).
14. Place new cap on catheter valve and twist it until it snaps into its locked position (*Diagram 12*).
15. Clean around catheter site with third alcohol pad (*Diagram 13*).

Diagram 10

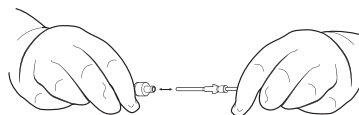

Diagram 11

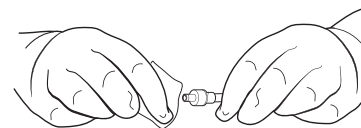

Diagram 12

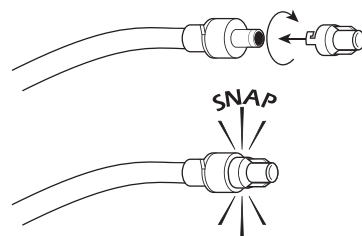
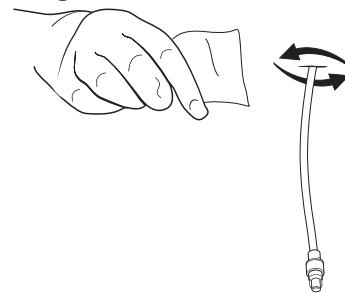

Diagram 13



This information was created and reviewed through a partnership with the UAMS Patient and Family Advisory Councils.

Drainage Instructions, continued

(Page 3 of 3)

16. Place foam catheter pad around catheter and wind catheter on top of pad. Cover catheter with gauze pads (*Diagram 14*).
17. Place self-adhesive dressing over gauze pads and remove plastic covering (*Diagram 15*).
18. Push down “T” plunger and move plunger in a circular motion to further puncture the foil seal so fluid can be poured out (*Diagram 16*).
19. Remove flexible cap and drainage line from bottle (*Diagram 17*).
20. Empty bottle into toilet. Place bottle in a plastic bag, seal tightly and discard.

Diagram 14

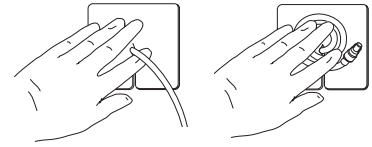

Diagram 15

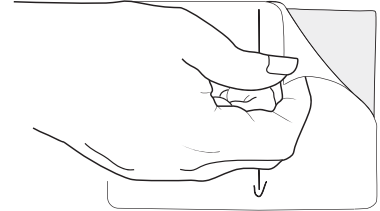
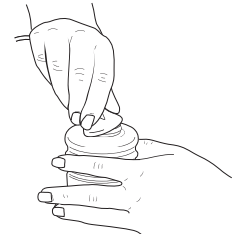

Diagram 16



Diagram 17



PleurX® is a registered trademark of CareFusion Corporation or one of its subsidiaries.

This information was created and reviewed through a partnership with the UAMS Patient and Family Advisory Councils.

UNIVERSITY OF ARKANSAS FOR MEDICAL SCIENCES
4301 West Markham Street - Little Rock, Arkansas 72205

Revised 4/18